



# D.I.D New Tech Chain

## Ultimate Life Chain Series

(Wear Resistant Chain Series)

# X-Ring Chain (LX)

### Upgraded with X-Ring!!

## The World's Lowest Friction Oil Sealed Roller Chain.

Next Generation Long Life Oil Sealed Roller Chain with patented X-Ring.

### Remarkable cost performance.

Considerable savings on running costs and maintenance costs by extending the chain life.

### Excellent Anti-Wear Performance.

X-Ring's outstanding sealing performance doubles the wear life of D.I.D O-Ring chain, already the best long life chain available.

### Dramatically reduced friction.

Achieved Half the Bending Force in articulations.

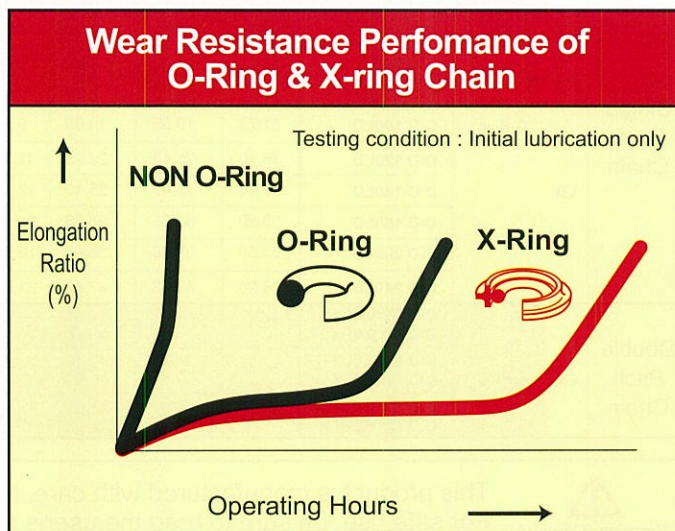
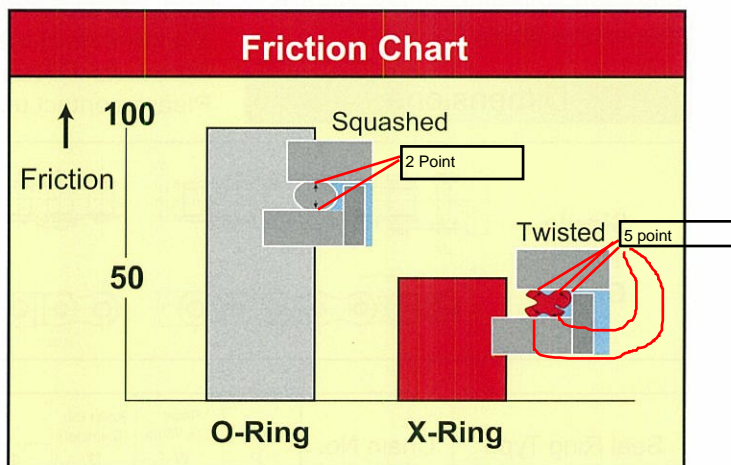

#### Function



#### Major Usage



# X-New Tech Chain -Ring Chain (LX)

**Ultimate Life Chain Series**  
Achieved a greater wear life than O-Ring chain with the patented X-Ring which dramatically reduces the friction. The greatest money saving chain, ever.

## Available Sizes

### Chain Size

#40 to 60 and C2040 to C2060H.  
Other sizes are O-Ring chain.  
Options : Multi-strand chain and attachment chain.

### Seal Ring Type

Material of X-Ring is nitrile rubber providing a greater heat resistance than conventional O-Ring.

## Connecting Links & Offset Links

### Connecting Links

(Clearance Fit / Semi-Press Fit Clip Type)  
#40 - 60, #C2040 - C2060H  
(Clearance Fit / Semi-Press Fit Cotter Type)  
#80, or #C2080H and larger

### Offset Links

2 Pitch Offset Links only.

## Sprockets

Standard multi-standard sprockets are not applicable.  
Sprockets with an extremely small number of teeth may not be applicable.  
Please contact us for details.



## Dimensions

### Single Pitch Chain

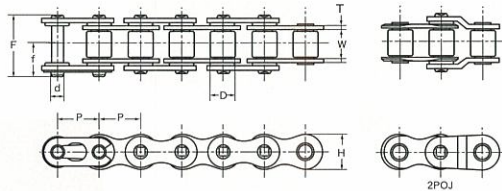

### Double Pitch Chain

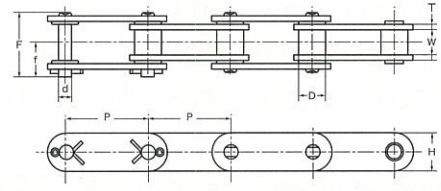

Unit (mm)

Seal Ring Type	Chain No.	Pitch P	Roller Link Width W	Roller Dia. (Diameter) D	Pin			Side Plates		Avg. Tensile Strength (Average Tensile Strength)		Max. Allowable Load (Maximum Allowable Load)		Approx. Weight (Approximate Weight) kg/m		
					d	F	f	T	H	kN	Kgf	kN	Kgf			
Single Pitch Chain	LD O-Ring	DID 35LD	9.525	4.60	5.08	3.59	14.45	7.8	1.25	9.0	9.8	1,000	1.47	150	0.35	
	LX X-Ring	DID 40LX	12.70	7.95	7.95	3.97	20.0	10.7	1.5	12.0	18.1	1,850	3.72	380	0.67	
		DID 50LX	15.875	9.53	10.16	5.09	23.9	12.8	2.0	15.0	30.1	3,070	6.86	700	1.08	
		DID 60LX	19.05	12.70	11.91	5.96	30.0	16.0	2.4	18.1	42.8	4,370	9.31	950	1.62	
	LD O-Ring	DID 80LD	25.40	15.88	15.88	7.94	38.9	20.9	3.2	23.9	72.5	7,400	14.7	1,500	2.83	
		DID 100LD	31.75	19.05	19.05	9.54	46.2	24.7	4.0	29.9	107.0	11,000	22.5	2,300	4.07	
		DID 120LD	38.10	25.40	22.23	11.11	56.8	30.2	4.8	35.9	156.9	16,000	30.4	3,100	5.90	
		BIG LD	DID 140LD	44.45	25.40	25.40	12.71	69.2	40.2	5.60	41.9	196	20,000	40.2	4,100	7.87
	DID 160LD		50.80	31.75	28.58	14.29	80.3	46.2	6.40	47.8	245	25,000	52.9	5,400	10.31	
	DID 200LD		63.50	38.10	39.68	19.85	96.5	55.0	8.00	60.0	428	43,700	73.5	7,500	16.89	
Double Pitch Chain	LX X-Ring	DID C2040LX	25.4	7.95	7.95	3.97	20.0	10.6	1.5	11.7	16.18	1,650	2.64	270	0.52	
		DID C2042LX														15.88
		DID C2050LX	31.75	9.53	10.16	5.09	23.9	12.7	2.0	15.1	27.45	2,800	4.41	450	0.87	
		DID C2052LX														19.05
		DID C2060HLX														38.10
DID C2062HLX	22.23															



Warning (Caution)

This product is manufactured with care, however inappropriate installation or use may result in injury. For safe use, be sure to read the user's manual carefully for Chain & Sprocket in our general catalog.

Distributed By:

**Did** DAIDO KOGYO CO., LTD.

TOKYO SALES DEPT.  
INDUSTRIAL PRODUCTS SALES & MARKETING DIV.  
3-5-4 NINGYO-CHO NIHONBASHI CHUO-KU,  
TOKYO 103-0013, JAPAN  
Phone: +81-3-3808-0781, Fax: +81-3-5695-7146  
Web Site: [www.did-daido.co.jp](http://www.did-daido.co.jp)



JQA-1122  
JQA-EM2110