A close-up photograph of a metal chain link. The link is made of a light-colored metal and has two circular holes. A circular stamp with the word 'KÖBO' is visible on the surface of the link. The background is dark, making the metal link stand out.

Endurance Chain

LUBE-FREE
MAINTENANCE FREE



LUBE FREE - MAINTENANCE FREE KÖBO ENDURANCE CHAIN

Plated Components for optimum-
Corrosion Protection
High Tensile Strength
High Load Bearing Surfaces



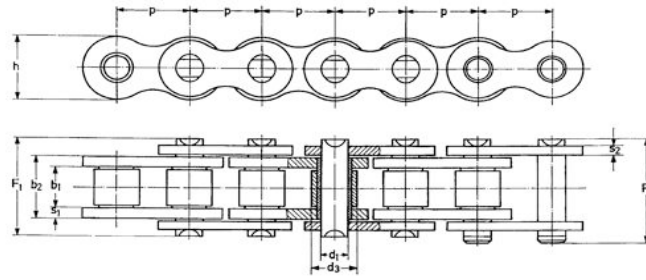

KÖBO Ref	p mm	b1 mm min	b2 mm max	d1 h mm	d3 mm max	F1 mm max	F2 mm max	h mm max	s1 mm	s2 mm	f cm2	FB N min	q kg/m
K06B1NLCH	9.525	5.72	8.53	3.28	6.35	13.5	16.8	8.2	1.3	1.3	0.28	9000	0.41
K06B2NLCH	9.525	5.72	8.53	3.28	6.35	23.8	27.1	8.2	1.3	1.3	0.56	16900	0.78
K08B1NLCH	12.7	7.75	11.3	4.45	8.51	17	20.9	11.8	1.6	1.6	0.5	18000	0.7
K08B2NLCH	12.7	7.75	11.3	4.45	8.51	31	34.9	11.8	1.6	1.6	1.01	32000	1.35
K10B1NLCH	15.875	9.65	13.28	5.08	10.16	19.6	23.7	14.7	1.6	1.6	0.67	22400	0.95
K10B2NLCH	15.875	9.65	13.28	5.08	10.16	36.2	40.3	14.7	1.6	1.6	1.34	44500	1.85
K12B1NLCH	19.05	11.68	15.62	5.72	12.06	22.7	27.3	16.1	1.8	1.8	0.89	29000	1.25
K12B2NLCH	19.05	11.68	15.62	5.72	12.06	42.2	46.8	16.1	1.8	1.8	1.79	57800	2.5
K16B1NLCH	25.4	17.02	25.4	8.28	15.88	36.1	41.5	21	4	3	2.1	60000	2.7
K16B2NLCH	25.4	17.02	25.4	8.28	15.88	68	73.4	21	4	3	4.21	106000	5.4
K16B1NLGLCH*	25.4	17.02	25.4	8.28	15.88	36.1	41.5	24	4	3	2.1	80000	2.7
K20B1NLCH	31.75	19.56	29.01	10.19	19.05	43.2	49.3	26.4	4.5	3.5	2.96	95000	3.6
K20B2NLCH	31.75	19.56	29.01	10.19	19.05	79	85.1	26.4	4.5	3.5	5.91	170000	7.2

* Straight side plates

Advantages of KÖBO Endurance Transmission Chain.

Due to the special pin and sintered bush, Endurance chain will give up to 35 x greater service life compared with standard oiled roller chains

In comparison to other maintenance free chains, Endurance will give up to 5 x greater service life.

There is no need for lubrication after installation

The chain bush is manufactured from a sintered metal and treated with a special lubricant

Chain pins are manufactured from a specially coated hardened steel alloy giving an extremely low wear rate and excellent bearing performance.

The Tensile strength of Endurance is equivalent to KÖBO premium.

All Endurance chains gear with the equivalent standard wheels.

Endurance transmission chain areas of application:

Chain speed up to 2.5 metres per second

Temperature range from freezing point to +100 degs celsius, up to 200 with special lubricant.

Ideal for the food industry

Electronics Industry

Packaging and printing

Textile industry

Any application where oil may cause a problem with contaminating the product.

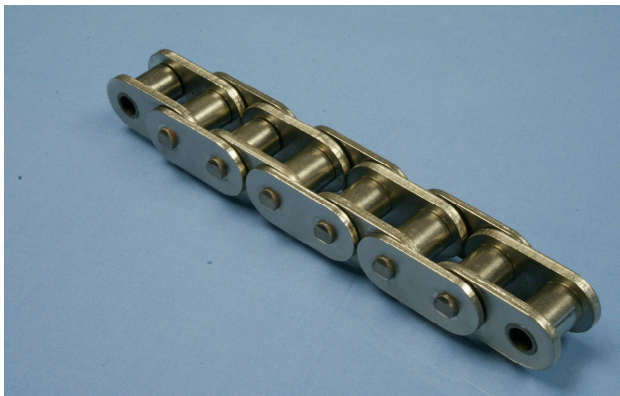

Straight side plate version shown. Ideal for conveying purposes, (standard chain is figure 8).





Plated corrosion resistant component parts



Solid sintered metal chain Bush

